

THE DEN LAYOUT

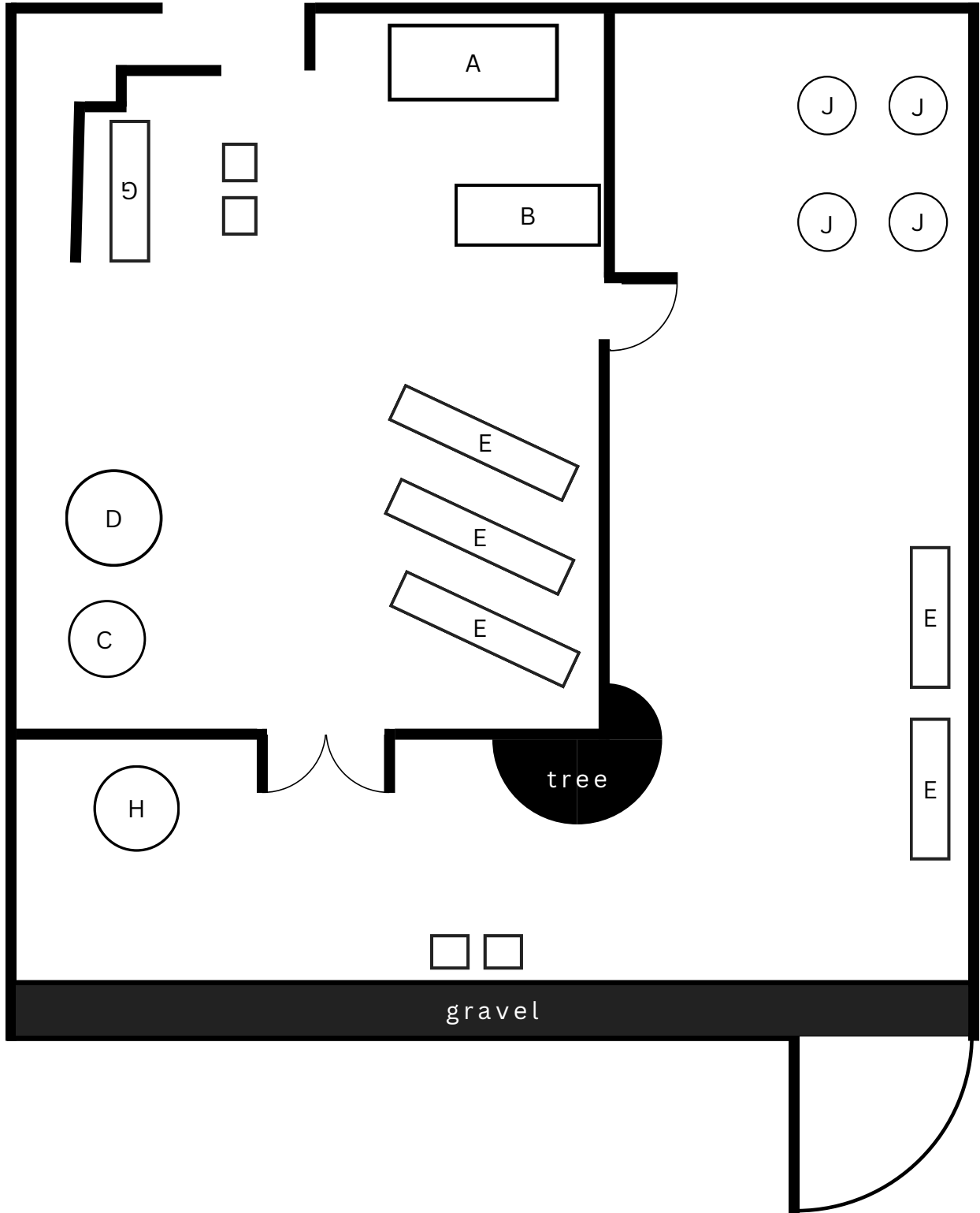

THE DEN INVENTORY

A // WOOD TOP + CINDER BLOCK LEG TABLE (86"x35");
CANNOT MOVE

B // LIVE EDGE WOOD BAR TOP (75"x50" at widest
point); CANNOT MOVE

C // 60" ROUND TABLE WITH 4 CHAIRS

D // 48" ROUND TABLE WITH 4 CHAIRS

E // VINTAGE BEER GARDEN TABLES (86.5"x19.5") WITH
2 BENCHES; SEATS 6-8 PER TABLE

G // 72" VELVET COUCH

H // 48" ROUND TABLE WITH 4 CHAIRS (OUTDOOR)

J // STRIPED BEAN BAG CHAIRS

ADDITIONAL ITEMS:

**available upon request*

- 10 ASSORTED VINTAGE CHAIRS
- 1 SET OF CORN HOLE BOARDS (WITH BAGS)
- BOARD GAMES, CARDS, + DOMINOES
- 3 RETRO IGLOO COOLERS (25-QT)
- 2 METAL TRASH CANS (31-GAL)